



SITE LAYOUT

NOTE: Drawing to be read in conjunction with TM1056-02-D-06 for details of Diversion Route

NOTE: Approximately 10m of Pedestrian Barrier Required for both Closure Points

NOTE: Minimum of 2 cone lamps on each closure point

NOTE: Closure length is approximately 220m

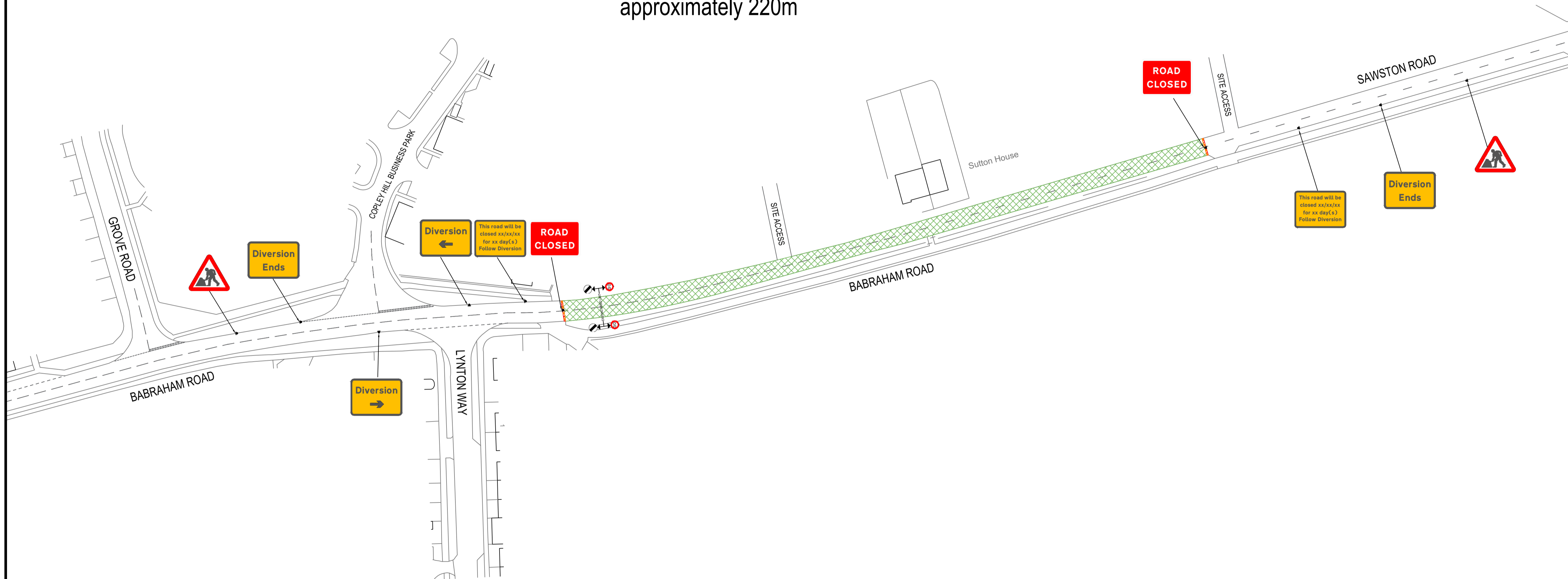

- NOTES:
- 1) All dimensions are in millimetres, unless stated otherwise.
 - 2) Do not scale from this drawing.
 - 3) TM will comply with the "Safety at Streetworks and Road works Code of Practise"
 - 4) All signing to be erected to "The Traffic Signs Manual Chapter 8" guidelines.
 - 5) This drawing may not show the normal roadworks signing that will be required (Refer to The "Traffic Signs Manual Chapter 8").

- KEY:
- Proposed Works Area
 - Safety Zones
 - Sign Location and Rotation
 - Pedestrian Barrier
 - Pedestrian Ramp

REVISIONS:

| REV | DESCRIPTION | INITIALS | DATE |
|-----|-------------|----------|------|
| | | | |
| | | | |

PROJECT: BABRAHAM ROAD
TEMPORARY TRAFFIC MANAGEMENT

TITLE: BABRAHAM RD, SAWSTON, CAMBRIDGE, CB22 3JH
TEMPORARY ROAD CLOSURE SITE LAYOUT
SHEET 1 OF 2



| | |
|-----------------|----------------------------|
| DESIGNED BY: BK | DRAWN BY: BK |
| CHECKED BY: AS | SCALE: NTS @ A1 |
| 11/06/2020 | DRAWING No: TM1056-02-D-05 |
| REV: - | |

© Crown Copyright 2020
Reproduction in whole or in part is prohibited
without prior permission of Ordnance Survey